

**POUDRE SCHOOL DISTRICT P-1
CACHE LA POUDE
ELEMENTARY
ADDITION & REMODEL
FT. COLLINS, COLORADO**

Rock, Brown, and Smith, Inc.
125 S. Howe, Suite 800
Fort Collins, CO 80521

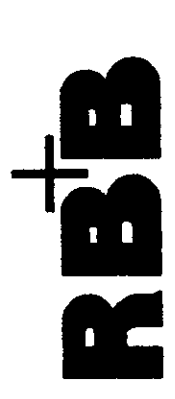

JOB NUMBER: 913
DRAWN: KTH/DFP
CHECKED: GFB
ISSUE: 10/07/92
REVISIONS: AS-BUILTS
SHEET NAME: INTERIOR ELEVATIONS
ELEVATION NUMBER: 92

THIS RECORD DRAWING HAS BEEN PREPARED BY THE ARCHITECT FROM INFORMATION FURNISHED BY OTHERS. WHILE THIS INFORMATION IS BELIEVED TO BE CORRECT, THE ARCHITECT ASSUMES NO RESPONSIBILITY FOR THE ACCURACY OF THIS RECORD DRAWING. THE ARCHITECT HAS CONDUCTED VISUAL CHECKS OF THIS RECORD DRAWING AND HAS INCORPORATED ANY CORRECTIONS WHICH MAY HAVE BEEN MADE. THE ARCHITECT HAS ADVISED TO THE CONTRACTOR THAT THE CONTRACTOR IS RESPONSIBLE FOR VERIFYING THE ACCURACY OF THIS RECORD DRAWING BEFORE APPLYING IT FOR ANY PURPOSE.

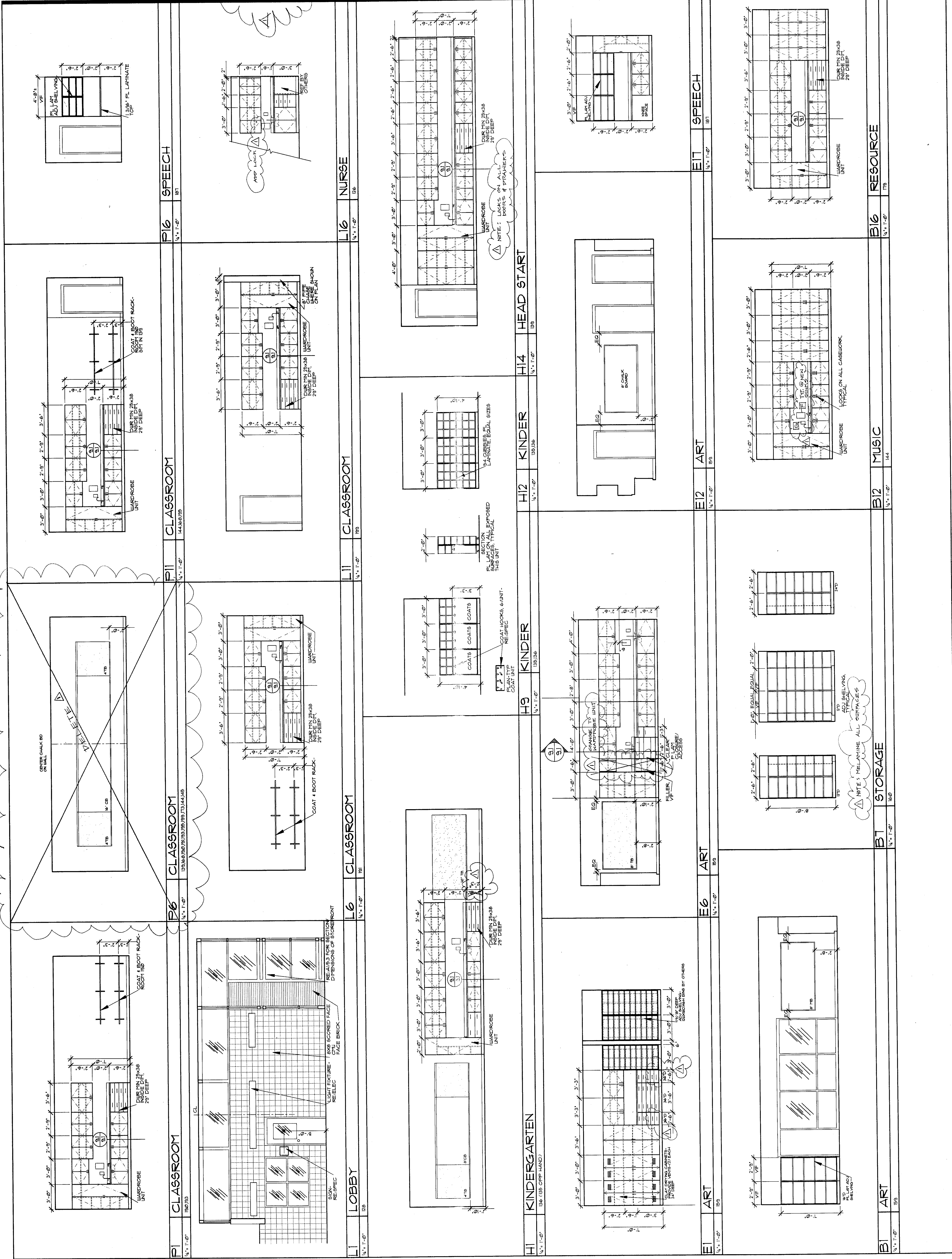

P1	CLASSROOM	136/193	1/4" = 1'-0"	181
P6	CLASSROOM	139, 140, 141, 142, 143, 144, 145	1/4" = 1'-0"	182
P11	CLASSROOM	144, 145, 146, 147	1/4" = 1'-0"	183
P16	SPEECH	181	1/4" = 1'-0"	184
L1	LOBBY	182	1/4" = 1'-0"	185
L6	CLASSROOM	181	1/4" = 1'-0"	186
L11	CLASSROOM	183	1/4" = 1'-0"	187
L16	NURSE	186	1/4" = 1'-0"	188
H1	KINDERGARTEN	136 (135 OFF HAND)	1/4" = 1'-0"	189
H9	KINDER	139, 138	1/4" = 1'-0"	190
H12	KINDER	139, 138	1/4" = 1'-0"	191
H14	HEAD START	185	1/4" = 1'-0"	192
E1	ART	183	1/4" = 1'-0"	193
E6	ART	183	1/4" = 1'-0"	194
E12	ART	183	1/4" = 1'-0"	195
E17	SPEECH	181	1/4" = 1'-0"	196
B1	ART	183	1/4" = 1'-0"	197
B16	MUSIC	144	1/4" = 1'-0"	198
B17	STORAGE	180	1/4" = 1'-0"	199
B18	RESOURCE	178	1/4" = 1'-0"	200